

HANDISWAGE™ LONG STUD

UNF - 316L STAINLESS STEEL

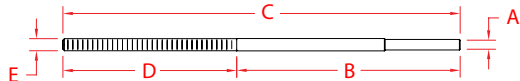

ITEM

A

B

C

D

E

QTY.

WT

(cable)

(thread)

(lb)

2 PACK

C0731-HL703-2

1/8"

4.50"

8.00"

3.50"

0.25"

2

0.18

NOTE:

DESIGNED FOR HAND SWAGE USE ONLY. The HandiSwage™ Long Stud is perfect for architectural cable railing applications where "through post" hardware is desired for minimal obstruction. Threads are "UNF". Crimp HandiSwage™ Studs onto cable using the Hand Swager (E0113-H600).

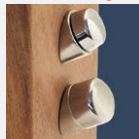

"30, 34 or 38 DEGREE STAIR SPACERS (2 PACK)"

Use in conjunction with the HandiSwage™ Long Stud to achieve angled cable runs on stairs. Install one of our cover nut options (sold separately) on the end of the threaded stud for a finished look.

HANDISWAGE™