

STAIR SPACER

316 STAINLESS STEEL

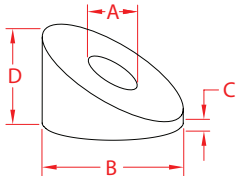

| ITEM | A | DEGREE | B | C | D | QTY | WT |
|------|---|--------|---|---|---|-----|----|
|------|---|--------|---|---|---|-----|----|

(size)

(lb)

2 PACK

C0841-0030-2

1/4"

30°

0.75"

0.07"

0.50"

2

0.07

C0841-0034-2

1/4"

34°

0.75"

0.004"

0.50"

2

0.07

C0841-0038-2

1/4"

38°

0.75"

N/A

0.59"

2

0.07



NOTE:

Use in conjunction with the RailEasy™ Stud Assembly or HandiSwage™ Studs to achieve angled cable runs on stairs. Install one of our cover nut options (sold separately) on the end of the threaded stud for a finished look.