



SUNRAIL[™] LATITUDE

New Look... Same Unobstructed View

The SunRail[™] Latitude features prefabricated 316L stainless steel posts and horizontal cable infill, utilizing RailEasy[™] round base tensioners and top rail mounting plates. These top rail mounting plates offer easy installation with virtually no hardware obstruction and allows customers to select their desired top rail.



CABLE RAILING INFILL

The SunRail[™] Latitude System is comprised of mechanical swage tensioners riveted to 2" outer diameter stainless steel posts to allow for cable railing infill. These RailEasy[™] Tensioners feature a compression fitting which enables installers to cut cable on-site, removing the hassle of pre-measuring and the cost of miscalculating dimensions. The cable used is a 5/32" diameter 1x19 strand cable. All fittings, cable and accessories are made from 316L stainless steel for maximum corrosion resistance. Standard cable spacing is less than 3" on-center.

HOW TO ORDER

The SunRail[™] Latitude can be purchased through a local authorized Atlantis Rail Dealer. To find a dealer near you, please visit the Dealer Locator on the Atlantis Rail website. You can also fax (508) 732-9798 or email info@atlantisrail.com a plan view layout with simple dimensions to Atlantis Rail for a quote. Call or click today to learn more about the SunRail[™] Latitude System.



SUNRAIL™ LATITUDE POST KITS

For easy ordering, the SunRail™ Latitude is offered as 3 post kit options in a 36" or 42" railing height. The post kits available are end posts, mid posts and corner posts. All post kits feature a 316L stainless steel 2" outer diameter tubular post in a polished finish. Cable spacing varies depending on post kit model. Consult installation instructions for complete details.

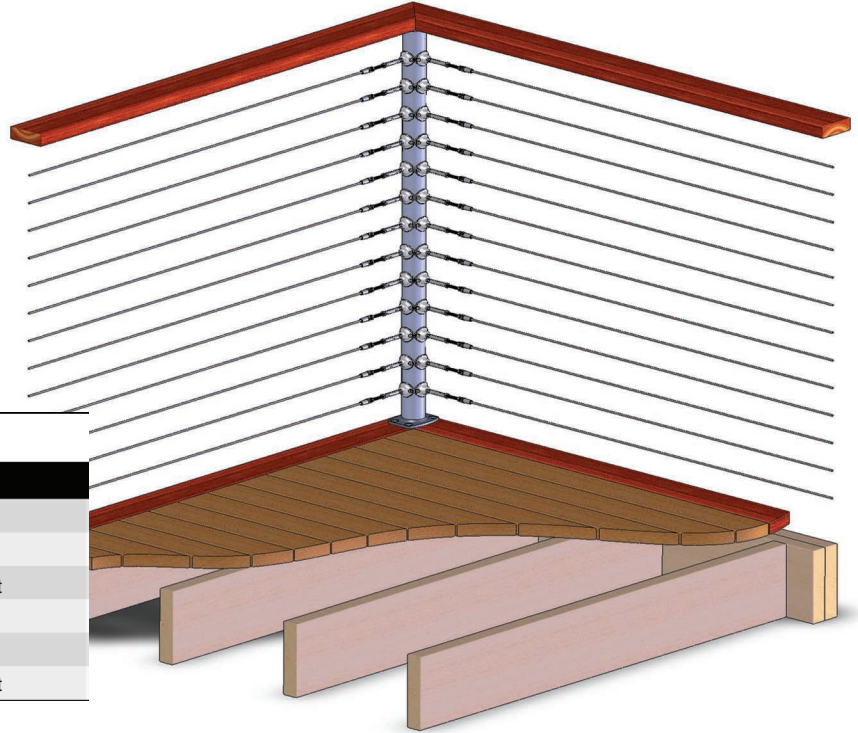

SunRail™ Latitude Components	
PART NUMBER	DESCRIPTION
S0952-E036	SunRail™ Latitude 36" End Post Kit
S0952-M036	SunRail™ Latitude 36" Mid Post Kit
S0952-C036	SunRail™ Latitude 36" Corner Post Kit
S0952-E042	SunRail™ Latitude 42" End Post Kit
S0952-M042	SunRail™ Latitude 42" Mid Post Kit
S0952-C042	SunRail™ Latitude 42" Corner Post Kit

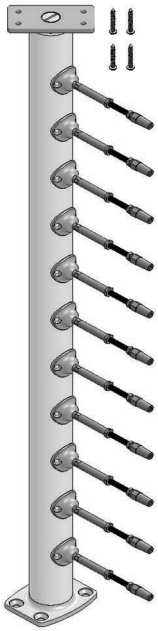

End Post Kits:

- 36" or 42" tube
- Top Plate Mounting Assembly (fasteners included)
- Mounting base (fasteners not included)
- 11 or 13 RailEasy™ Tensioners Round (depending on height)

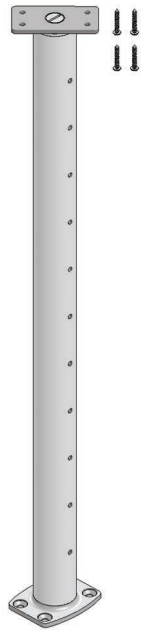

Mid Post Kits:

- 36" or 42" tube
- Top Plate Mounting Assembly (fasteners included)
- Mounting base (fasteners not included)
- 11 or 13 pre-drilled holes for running cable

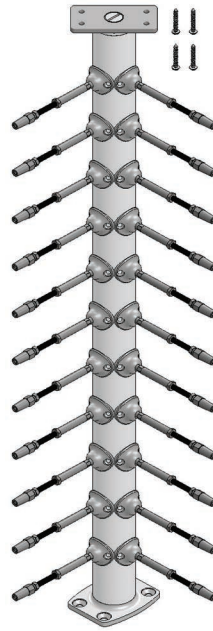

Corner Post Kits (for 90° corners):

- 36" or 42" tube
- Top Plate Mounting Assembly (fasteners included)
- Mounting base (fasteners not included)
- 22 or 26 RailEasy™ Tensioners Round (depending on height)

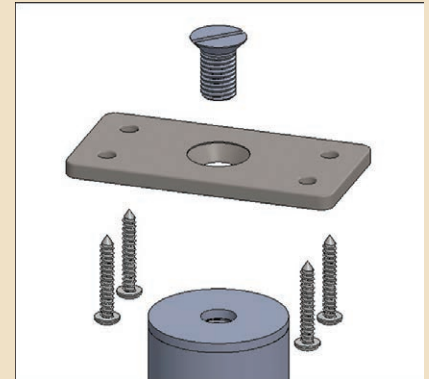

Top Plate Mounting Assembly

This assembly allows for the easy installation of a customer supplied flat top rail. A cap is pre-welded to the post which is then fastened to a stainless plate. Wood screws are drilled up into the top rail.

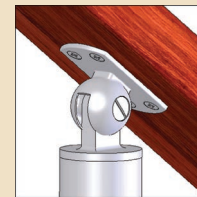

Stair Fitting S0902-0409

The SunRail™ Latitude has the ability to fit any design situation including stair and fascia mounting applications.

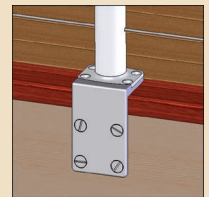

Fascia Mount S0950-0002