

RAILEASY™ TUBING

316L STAINLESS STEEL

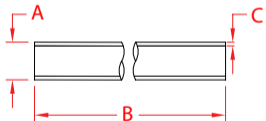

ITEM	SIZE	A	B	C	WT
					(lb)
<i>POLISHED - BY THE FOOT</i>					
S0900-0038	1-1/2"	1.50"	12.00"	0.062"	0.85
S0900-0050	2"	2.00"	12.00"	0.062"	1.34
<i>BRUSHED - BY THE FOOT</i>					
S0900-B038	1-1/2"	1.50"	12.00"	0.062"	0.85
S0900-B050	2"	2.00"	12.00"	0.062"	1.34
<i>POLISHED - STANDARD LENGTHS</i>					
C0973-0900	2"x 36"	2.00"	36.00"	0.062"	4.02
C0973-1200	2"x 48"	2.00"	48.00"	0.062"	5.36

NOTE: Stainless steel tubing is type 316L. Standard lengths of 3 feet, 4 feet and 5 feet are used as top and bottom rails for the RailEasy™ and SunRail™ systems. Tubing is available in a highly polished or brushed finish.